

## Plastic Fan Blades

### Features

- Lightweight and Durable
- Reduce Air Noise
- Improved Motor Bearing Life
- Eliminate Bent Blades

### Fixed - Hub Type

Part #	Bore	Rotation	Diameter	# of Blades
93-40421	1/8"	CW	4.00"	4
93-40522	1/8"	CCW	4.00"	5
93-45522	1/8"	CCW	4.50"	5
93-35431	3/16"	CW	3.50"	4
93-40531	3/16"	CW	4.00"	5
93-60431	3/16"	CW	6.00"	4
93-50432	3/16"	CCW	5.00"	4
93-55432	3/16"	CCW	5.50"	4
93-60432	3/16"	CCW	6.00"	4
93-40541	1/4"	CW	4.00"	5
93-65571	7/32"	CW	6.50"	5



### Impeller Type

Part #	Diameter	Width	Shaft Size
93-A7100	4.50"	1.0625"	7/32" (W/ FLAT)
93-A7105	5.00"	1.25"	7/32 (EB50)

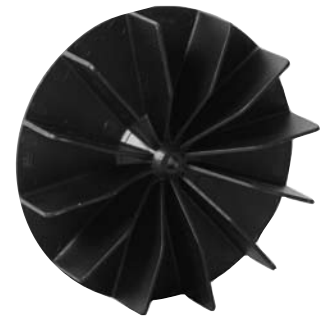

### Unit Bearing - Hubless Type

Part #	Rotation	Diameter	# of Blades
93-A7353	CCW	4.00"	4
93-A7351	CW	4.00"	5
93-A7352	CCW	4.00"	5



### Flue Exhaust Motor Cooling Blades

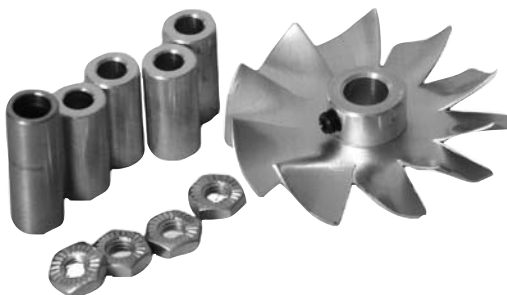

1 3/4" Diameter  
5/16" Hub I.D. with 1/4"

**Keeprite - Blade Only**  
504015K

**92-FMK** CW ROTATION  
**92-FMK1** CCW ROTATION

**93-31042** 3" x 1/4"  
**93-41042** 4" x 1/4"

## Metal Fan Blades

### Unit Bearing - Hubless Type



#### Typical Applications

- Freezers
- Refrigerators

#### Features

- 7" - 10" Diameter
- High Quality Aluminium Blades

### 5 Blades

Part #	Rot	Dia	Pitch	
93-A7022	CW	7"	15°	
93-A7023	CW		20°	
93-A7024	CCW		20°	
93-A7025	CW		25°	
93-A7026	CW		30°	
93-A7027	CCW		30°	
93-A7005	CW		38°	
93-A7028	CW		40°	
93-A7030	CW		7 3/4"	21°
93-A7033	CW		8"	25°
93-A7034	CW	30°		
93-A7035	CCW	30°		
93-A7029	CCW	30°		
93-A7042	CW	40°		
93-A7036	CCW	40°		
93-A7039	CW	8 3/4"		30°
93-A7040	CCW			30°
93-A7041	CW	10"	23°	

### 3 Blades

Part #	Rot	Dia	Pitch
93-A7332	CW	7"	32°
93-A7008	CW	7 3/4"	18°
93-A7009	CW		32°
93-A8332	CW	8 1/2"	32°
93-A7014	CCW	8 3/4"	30°
93-A7018	CW	9 1/2"	20°

#### Performance Tables

Order By : Part number or Diameter,  
Pitch and Number of blades

### One Piece - Fixed Hub Type

#### Features

- 5 Blade
- 5 1/2" - 10" diameter
- High quality aluminium blades
- CW fans have hub attached on discharge side
- CCW fans have hub attached on intake side
- Zinc and chromate coated hub
- For motor speeds up to 3450 RPM

#### Typical Applications

- Freezers
- Refrigerators
- Heaters

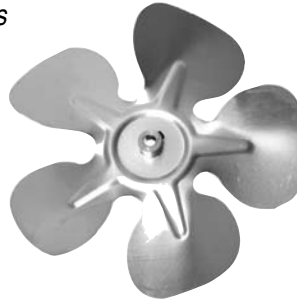

#### Performance Tables

Order By : Part number or Diameter,  
Pitch and Number of blades

Part #	Rot	Dia	Pitch	Bore	Replace
93-6-4587	CW	5 1/2"	27°	1/4"	GE7451
93-6-4588	CCW	5 1/2"	27°	1/4"	GE7452
93-6-4589	CW	5 1/2"	27°	5/16"	GE7551
93-6-4590	CCW	5 1/2"	27°	5/16"	GE7552
93-6-4591	CW	7"	27°	1/4"	GE7471
93-6-4592	CCW	7"	27°	1/4"	GE7472
93-6-4593	CW	7"	27°	5/16"	GE7571
93-6-4594	CCW	7"	27°	5/16"	GE7572
93-6-4595	CW	8"	24°	1/4"	GE7481
93-6-4596	CCW	8"	24°	1/4"	GE7482
93-6-4597	CW	8"	24°	5/16"	GE7581
93-6-4598	CCW	8"	24°	5/16"	GE7582
93-6-4599	CW	8"	32°	1/4"	GE7483

Part #	Rot	Dia	Pitch	Bore	Replace
93-6-4600	CCW	8"	32°	1/4"	GE7484
93-6-4601	CW	8"	32°	5/16"	GE7583
93-6-4602	CCW	8"	32°	5/16"	GE7585
93-6-4603	CW	9"	26°	1/4"	GE7491
93-6-4604	CCW	9"	26°	1/4"	GE7492
93-6-4605	CW	9"	26°	5/16"	GE7591
93-6-4606	CCW	9"	26°	5/16"	GE7592
93-6-4607	CW	10"	20°	1/4"	GE7493
93-6-4608	CCW	10"	20°	1/4"	GE7494
93-6-4609	CW	10"	20°	5/16"	GE7593
93-6-4610	CCW	10"	20°	5/16"	GE7594
93-6-4611	CW	10"	31°	5/16"	GE7595
93-6-4612	CCW	10"	31°	5/16"	GE7596

## Free-Air Type Fan Blades - Interchangeable Hub

### Typical Applications

- Pedestal Fans
- Wall and Roof Exhausters
- Air Circulators
- Window Fans
- Commercial Ventilation Equipment
- Unit Heaters

### 3 Blades

Part #	Rot	Dia	Pitch
93-6-4300	CW		23°
93-6-4301	CCW		23°
93-6-4302	CW		27°
93-6-4303	CCW		27°
93-6-4304	CW		23°
93-6-4306	CW		27°
93-6-4308	CW		23°
93-6-4309	CCW		23°
93-6-4312	CW		23°
93-6-4313	CCW		23°
93-6-4314	CW		27°
93-6-4315	CCW		27°
93-6-4316	CW		23°
93-6-4318	CW		23°
93-6-4320	CW		12°
93-6-4321	CCW		12°
93-6-4322	CW		18°

### 4 Blades

Part #	Rot	Dia	Pitch
93-6-4324	CW		23°
93-6-4325	CCW		23°
93-6-4326	CW	10"	27°
93-6-4328	CW		33°
93-6-4329	CCW		33°
93-6-4330	CW		23°
93-6-4331	CCW		23°
93-6-4332	CW	12"	27°
93-6-4333	CCW		27°
93-6-4334	CW		33°
93-6-4335	CCW		33°
93-6-4336	CW		23°
93-6-4337	CCW		23°
93-6-4338	CW	14"	27°
93-6-4339	CCW		27°
93-6-4340	CW		33°
93-6-4341	CCW		33°

### 4 Blades (cont.)

Part #	Rot	Dia	Pitch
93-6-4342	CW		23°
93-6-4343	CCW		23°
93-6-4344	CW	16"	27°
93-6-4345	CCW		27°
93-6-4347	CCW		33°
93-6-4348	CW		23°
93-6-4350	CW	18"	27°
93-6-4351	CCW		27°
93-6-4353 <sup>1</sup>	CCW		33°
93-6-4354	CW		23°
93-6-4355	CCW		23°
93-6-4356	CW	20"	27°
93-6-4357	CCW		27°
93-6-4358 <sup>2</sup>	CW		33°
93-6-4359 <sup>2</sup>	CCW		33°
93-6-4362 <sup>2</sup>	CW		18°
93-6-4363 <sup>2</sup>	CCW		18°
93-6-4354 <sup>2</sup>	CW	24"	23°
93-6-4365 <sup>2</sup>	CCW		23°
93-6-4367 <sup>2</sup>	CCW		27°



### Features

- 3 or 4 Blade
- 10" - 24" diameter
- High quality heavy duty aluminium blades
- Maximum air delivery, minimum noise
- Zinc and dichromate plated steel spiders
- For motor speeds up to 1725 RPM

### Performance Tables

Order By : Part number or Diameter, Pitch and Number of blades  
 1 = Rated to 1550 RPM  
 2 = Rated to 1140 RPM

## Pressure (condenser) Type Fan Blades - Interchangeable Hub

### Typical Applications

- Air Conditioning Condensers
- Power Roof Ventilators
- Heat Pumps
- Heat Exchangers
- Commercial & Industrial Equipment
- Unit Heaters



### 2 Blades

Part #	Rot	Dia	Pitch
93-6-4941	CCW	18"	27°
93-6-4942	CCW	20"	25°
93-6-4943	CCW	22"	18°
93-6-4944	CCW		27°

### 3 Blades

Part #	Rot	Dia	Pitch
93-6-4368	CW		27°
93-6-4369	CCW	18"	27°
93-6-4371	CCW		30°
93-6-4372	CW		33°
93-6-4374	CW		24°
93-6-4377	CCW	20"	28°
93-6-4379	CCW		31°
93-6-4382	CW	22"	35°
93-6-4383	CCW		35°
93-6-4384	CW		26°
93-6-4386	CW	24"	33°
93-6-4387	CCW		33°

### Features

- 18" - 24" diameter
- High quality heavy duty aluminium blades
- Maximum air delivery, minimum noise
- Zinc and dichromate plated steel spiders
- For motor speeds up to 1140 RPM

### Performance Tables

Order By : Part number or Diameter, Pitch and Number of blades

## Pressure (condenser) Type Fan Blades - Interchangeable Hub

### Typical Applications

- Air Conditioning Condensers
- Power Roof Ventilators
- Heat Pumps
- Heat Exchangers
- Commercial & Industrial Equipment
- Unit Heaters

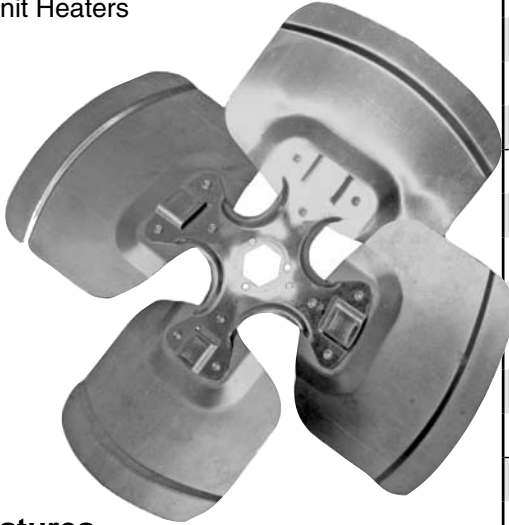

### Features

- 10" - 26" diameter
- High quality heavy duty aluminium blades
- Maximum air delivery, minimum noise
- Zinc and dichromate plated steel spiders
- For motor speeds up to 1625 RPM

### 4 Blades

Part #	Rot	Dia	Pitch
93-6-4328	CW	10" <sup>m2</sup>	33°
93-6-4329	CCW		33°
93-6-4330	CW	12" <sup>m2</sup>	23°
93-6-4331	CCW		23°
93-6-4334	CW		33°
93-6-4335	CCW	14"	33°
93-6-4388	CW		23°
93-6-4389	CCW		23°
93-6-4390	CW	16"	33°
93-6-4391	CCW		33°
93-6-4392	CW	18"	23°
93-6-4393	CCW		23°
93-6-4394	CW		33°
93-6-4396	CW	18"	27°
93-6-4397	CCW		27°

### 4 Blades (cont.)

Part #	Rot	Dia	Pitch
93-6-4402	CW	20"	26°
93-6-4403	CCW		26°
93-6-4404	CW	22"	29°
93-6-4406	CW		33°
93-6-4407	CCW		33°
93-6-5736	CW	24"	23°
93-6-5741	CCW		23°
93-6-4408	CW	26"	27°
93-6-4409	CCW		27°
93-6-4411	CCW		35°
93-6-5737	CW	24"	18°
93-6-5738	CW		23°
93-6-5743	CCW	26"	23°
93-6-4412	CW		27°
93-6-4413	CCW		27°
93-6-4414	CW	26"	33°
93-6-4415	CCW		33°
93-6-4416	CW	26"	27°
93-6-4419	CCW		27°

### Performance Tables

Order By : Part number or Diameter, Pitch and Number of blades

## Interchangeable Hex Hubs

Part #	Dia.	# Of Set Screws
93-217-002	5/16"	1
93-217-003	3/8"	1
93-217-004	1/2"	2
93-217-004	5/8"	2

### Fits All Interchangeable Hub Type Fan Blades

- Pre-tapped holes with mounting & set screws started
- Packaged 12/carton; Order in multiples of 12/size
- Bore sizes to fit most field applications
- Zinc & dichromate plated alloy steel
- Simple screw design



## Pressure (condenser) Type Fan Blades - Fixed Hub

### Typical Applications

- Air Conditioning Condensers
- Power Roof Ventilators
- Heat Pumps
- Heat Exchangers
- Commercial & Industrial Equipment
- Unit Heaters



### Features

- 14" - 24" diameter
- High quality heavy duty aluminium blades
- 1/2" bore, shaved & staked hub, attached on intake side
- Zinc and dichromate plated steel spiders
- For motor speeds up to 1625 RPM

### 3 Blades

Part #	Rot	Dia	Pitch
93-6-4227	CW	14"	33°
93-6-4228	CCW		33°
93-6-4229	CW	16"	33°
93-6-0896	CW	18"	33°
93-6-4231	CCW		33°
93-6-0899	CW	20"	33°
93-6-4232	CCW		33°
93-6-4233	CW	22"	33°
93-6-4235	CW	24"	33°

### 4 Blades

Part #	Rot	Dia	Pitch
93-6-4238	CW	16"	33°
93-6-4240	CW	18"	33°
93-6-4241	CCW		33°
93-6-4242	CW	20"	33°
93-6-4245	CCW	22"	33°
93-6-4246	CW	24"	33°
93-6-4247	CCW		33°

### Performance Tables

Order By : Part number or Diameter, Pitch and Number of blades



## Heavy Duty, All Steel Type Fan Blades

### Typical Applications

- Commercial Air Conditioning & Ventillation
- Air Handlers
- Cooling Towers
- Agricultural Applications
- Large Unit Heaters

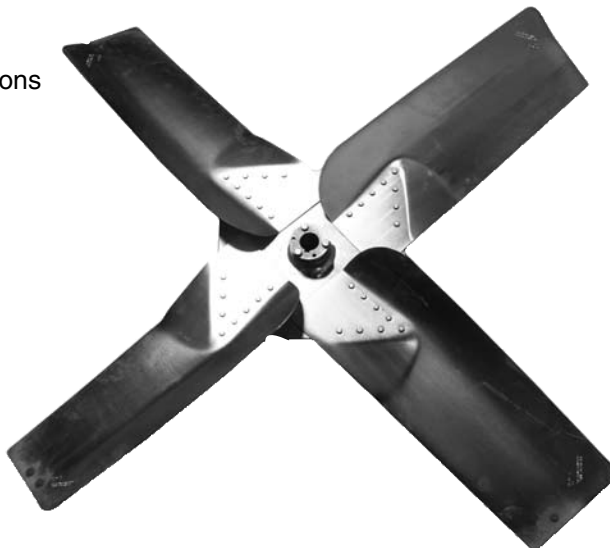

Part #	Rot	Dia	Pitch
93-5-2186*	CW	26" <sup>2</sup>	
93-5-2225		26"	
93-5-2241		28"	38°
93-5-2190		36"	
93-5-2191		42"	

### Performance Tables

Order By : Part number or Diameter, Pitch and Number of blades

\* = Furnished with 3/4" fixed bore hub on discharge side. Comes with 2 set screws and standard keyway. Key not included.

## Split Tapered Bushings

### Features

- For 1/2" - 1-3/8" bore ranges
- Malleable iron construction
- Two-bolt design
- Two 1/4-20 x 3/4" cap screws provided
- Packaged individually



Part #	Pitch	Part #	Pitch
67-QH1/2	1/2"	67-QH1	1"
67-QH5/8	5/8"	67-QH1-1/8	1 1/8"
67-QH3/4	3/4"	67-QH1-3/16	1 3/16"
67-QH7/8	7/8"	67-QH1-3/8	1 3/8"

## Blower Wheel Pullers



### \*Blower Wheel Puller Kit

92-CD3570

Includes all sizes plus a carrying case

Part #	Discription
92-CD3500	Drive Bolts, Shank & 1 1/4" Hub
92-CD3510	Drive Bolts, Shank & 1 3/8" Hub
92-CD3520	Drive Bolts, Shank & 1 1/2" Hub
92-CD3530	Drive Bolts, Shank & 1 5/8" Hub
92-CD3505*	1 1/4" Hub Only
92-CD3515*	1 3/8" Hub Only
92-CD3525*	1 1/2" Hub Only
92-CD3535*	1 5/8" Hub Only
92-CD3540*	Pin & Drive Bolt
92-CD3555	Set Screw (3/Pkg.)
92-CD3560*	5/32" Allen Wrench
92-CD3565*	1" Sears Adapter